

Pola Day and Pola Night are high viscosity, neutral pH take home tooth whitening gels. Both are pleasantly flavoured, crystal clear sustained release gels with a unique blend of soothers, conditioners and a water content high enough to further reduce sensitivity.

INDICATIONS FOR USE:

- Whitening of discoloured vital teeth.
- Whitening of discoloured non-vital teeth.

COMPOSITION:

Pola Day 3.0-9.5% wt Hydrogen peroxide
 < 47% wt Additives
 30% wt Glycerol
 20% wt Water
 0.1% wt Flavour

TREATMENT GUIDELINES:

Pola Day	9.5%
	2 x 15 minutes/day or 1 x 30 minutes / day

FOR EFFECTIVE RESULTS:

- Do not eat, drink or smoke during treatment.
- Do not smoke immediately after treatment - wait for at least two hours.
- Foods and drinks containing strong colours should be avoided for at least 48 hours after the treatment period or consumed in moderation.
- Use gel at room temperature.

STORAGE AND SHELF LIFE:

- Store in a cool and out of direct sunlight at temperatures between (2°-25°C / 35°-77°F).
- Do not use after expiration date.

PRECAUTIONS:

- To be used under the supervision of a dentist.
- Keep out of reach of children and pets.
- Not to be used by pregnant or lactating women or children under 14 years old.
- Patients with a history of chemical allergies are advised to carry out allergy testing by a specialist before using these products.
- Discontinue use if any unusual sensitivity or reactions occur and consult your dentist.
- Do not inject Pola Day or Pola Night into the body.
- CAUTION: FEDERAL LAW RESTRICTS THIS DEVICE TO SALE BY OR ON THE ORDER OF A DENTIST.
- MSDS available at www.sdi.com.au or contact your regional representative.

FIRST AID:

- **Eye (contact):** Wash thoroughly with water and seek medical advice if symptoms persist.
- **Skin (contact):** Wash thoroughly with water and seek medical advice if symptoms persist.
- **Ingestion (large amount):** Drink plenty of milk or water and seek medical advice.

PLACEMENT PROCEDURE:

1. Place a small drop of gel into every compartment of the tray for the teeth undergoing treatment.
2. Seat the tray, with the gel around the teeth.
3. Wipe away excess gel in mouth with a tissue or dry soft brush.
4. After treatment, remove tray. Rinse tray and mouth with lukewarm water.
5. Brush teeth.

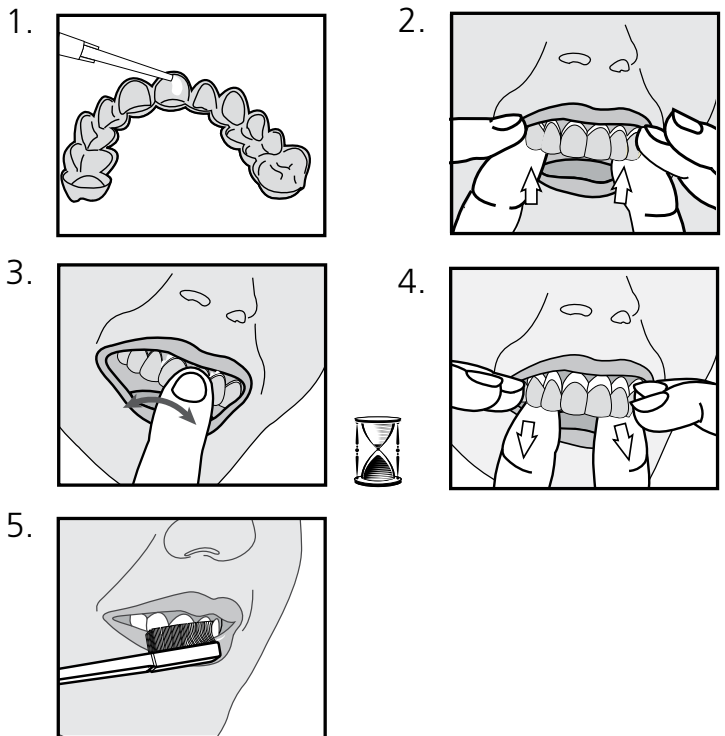

USA & Canada 1 800 228 5166
www.sdi.com.au
www.polawhite.com.au

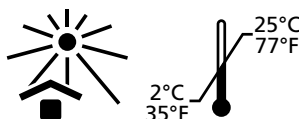

Warning



Causes
skin & eye
irritation